

CAPE CAMDEN #105

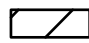

FRONT

 HOLD BACK GYPBD 1'-0" PER
SIDE IN OPEN AREAS
STAIRS DESIGNED TO 8 1/4" RISE
MAX., AND 9" TREAD MIN W/ 1 1/8" NOSING

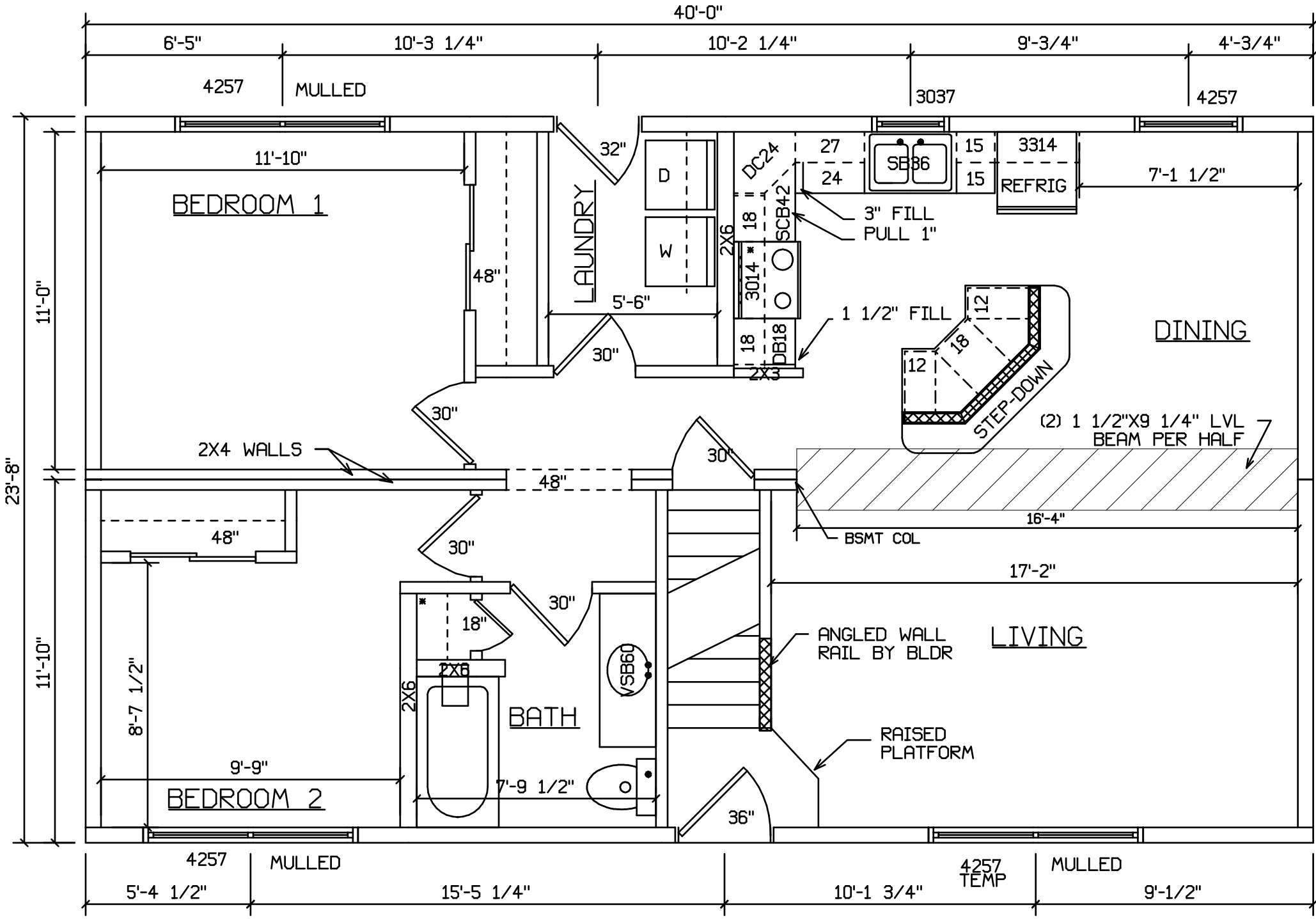

SITE LOCATION

HOLD BACK GYPBD 1'-0" PER SIDE IN OPEN AREAS

STAIRS DESIGNED TO 8 1/4" RISE MAX., AND 9" TREAD MIN W/ 1 1/8" NOSING

BLDR/DEVL. AUTHORIZATION	DATE	# LABEL LOCATION CLG HGTH	<i>Gregory J. Hayes</i> Production Engineer	SUPERIOR BUILDERS 1565 PA. RT. 442 E. MUNCY, PA. 17756 A DIVISION OF MUNCY HOMES, INC.	REV.
MANUF. AUTHORIZATION	DATE	PLANS HAVE BEEN EXTRACTED FROM APPROVED BLDG SYSTEM DOCUMENTATION			DATABASE
		DWN BY LITZ	DATE 8-18-99		SCALE 1/4"=1'-0"
				BLDR / CUST	

CAPE CAMDEN #105
WITH OPTIONAL 60" DORMERS

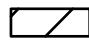

FRONT

 HOLD BACK GYPBD 1'-0" PER
SIDE IN OPEN AREAS
STAIRS DESIGNED TO 8 1/4" RISE
MAX., AND 9" TREAD MIN W/ 1 1/8" NOSING